

# SERIES VS SNAP-ACTION SWITCHES

## Electrical Specifications

Dielectric Strength.....1000 VAC 50/60Hz for 1 minute  
 Insulation Resistance.....100 Megohms (Minimum)  
 Contact Resistance.....30 miliohms maximum (initial)

Service Life  
 Mechanically.....100,000,000 operations Minimum  
 Electrically.....200,000 operations Minimum

### APPROVALS:

UL & CSA.....Standard Force  
 1/2 HP 125 VAC, 15A 125/250 VAC  
 Light Force  
 15A 125 VAC/250 VAC

### TERMINATIONS:

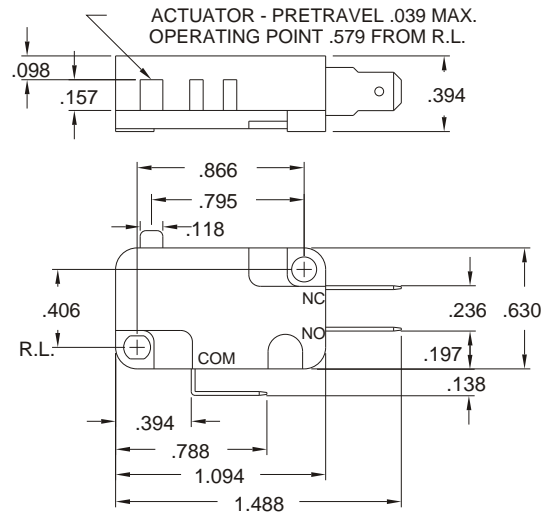
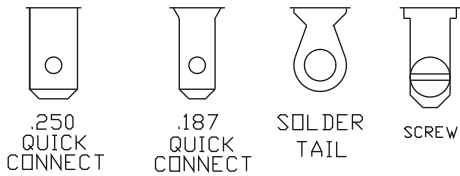

Base No.	Current Rating	Cover Material	Lever Type	Contact	Terminal
VS	10 = 10A 125 VAC or 250 VAC 15 = 15A 125 VAC or 250 VAC	N = Nylon	00 = No Lever 01 = Type 01 02 = Type 02 03 = Type 03 04 = Type 04 05 = Type 05 06 = Type 06	1 = NC & NO 2 = NC 3 = NO	A = Solder Terminal B = Screw Terminal C = .250 Quick Connect C2 = .187 Quick Connect

NOTE: For other lever types please consult factory

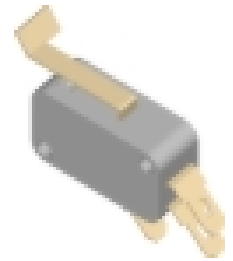

### LEVER OPTIONS:

TYPE 01    A = 0.870  
 TYPE 02    A = 1.402  
 TYPE 03    A = 2.449

TYPE 05    A = 0.791  
 TYPE 06    A = 1.339

