

66PI

Mini Rocker Switch, 10A DPDT 3-Position
Momentary On-Off-Momentary On

<https://www.gamainc.com/product/66pi/>

Available Accessories

- 1-Gang Panel ([66-1G](#))
- 2-Gang Panel ([66-2G](#))
- 3-Gang Panel ([66-3G](#))

GAMA ELECTRONICS

P.O. Box 1488, Crystal Lake, IL 60039

Phone: 815-356-9600

Fax: 815-356-9603

Email: gama@gamainc.com

www.gamainc.com

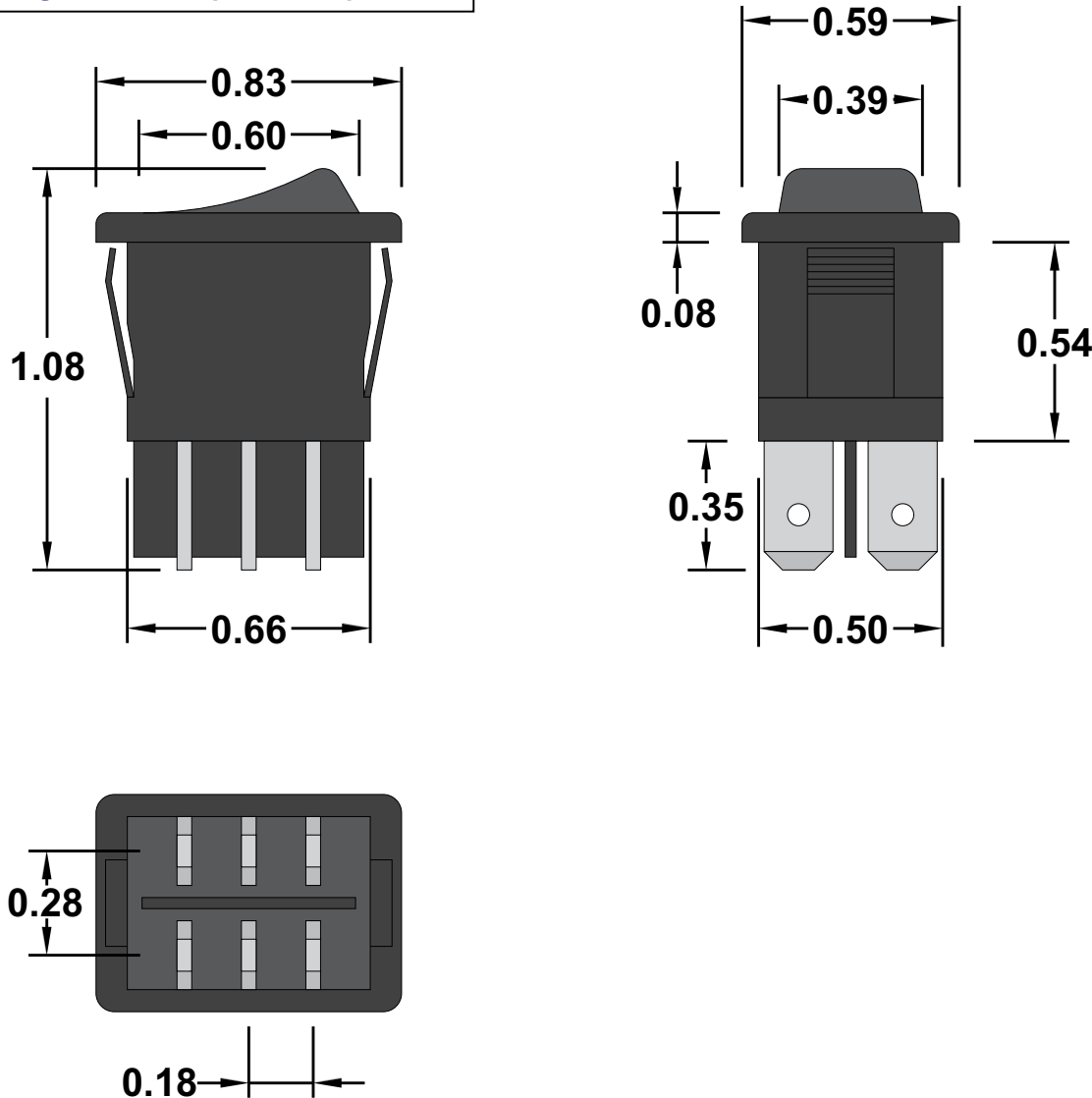

Specifications

•Circuit Code: Double Pole Double Throw (On)-Off-(On)*

*() Denotes Momentary

•Rating: 12A 125VAC, 6A 250VAC, 6A 12VDC

•Terminals: 3/16" Quick Connect

•Black Body & Button

Circuit Diagram

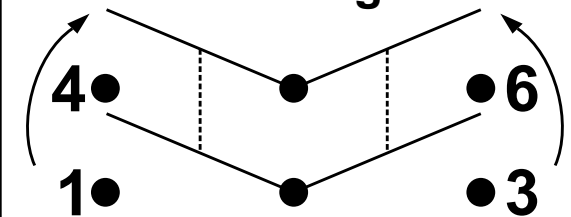

Mounting Hole

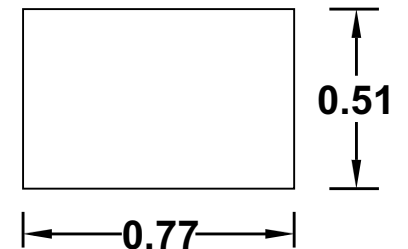

Drawn By: KEG

Information contained herein is proprietary information of GAMA Electronics Inc. The dissemination use or duplication of this information, for any purpose other than that for which the information is provided, is prohibited except by express written permission.

All dimensions are in inches and have a +/- .015" tolerance unless otherwise specified.

Rev: A

Pg. 1 of 1

Release Date: 08/06/18

Third Angle Projection

